

# G-6 Shifter Kit



Street & performance 479-394-5711 [www.hotrodlane.cc](http://www.hotrodlane.cc)

This kit is designed for the 6 speed automatic transmission applications with tap up, tap down mode is desired. When installing this application, install the shifter securely and wrap the shifter cable away from the exhaust avoiding tight radius and kinks in the cable.

Complete modified shifter and cable combination can be purchased through Street & Performance.

## STEP 1:

Remove the factory shifter cable ball stud by drilling from the opposite side center with a 3/16" drill bit. The stud should come out the cleaned up hole with 1/4"

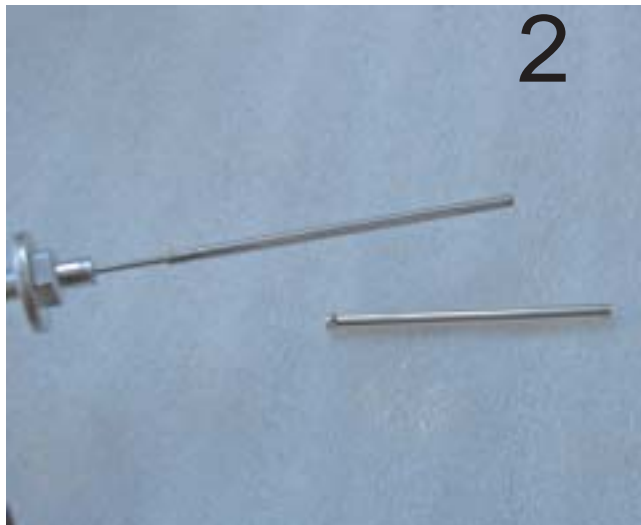
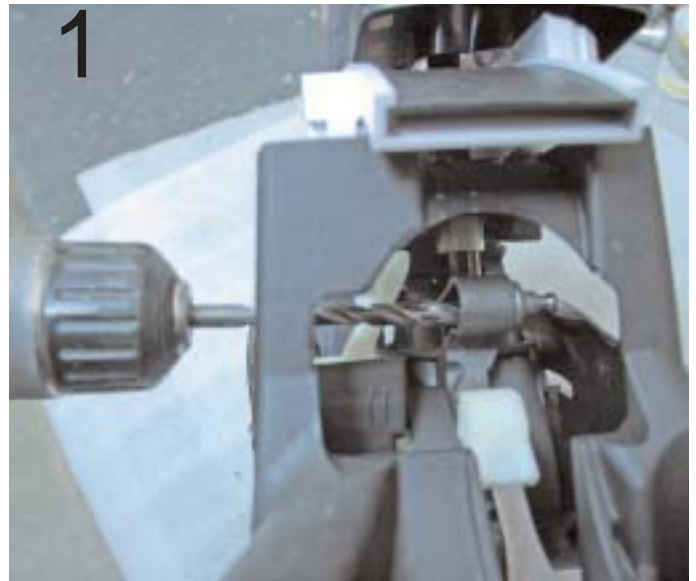

## STEP 2:

Remove jam nut and rubber protector from one end of the cable. Pull out 1/4" swivel tubing from the shifter cable end. Remove 1/4" of tubing. Snap tubing back into cable and reinstall rubber protectors.

## STEP 3:

Install shifter cable stud, 1/4X28 with 10/32 inset. Snug the stud leaving enough play to slightly swivel.



Shifter cable stud

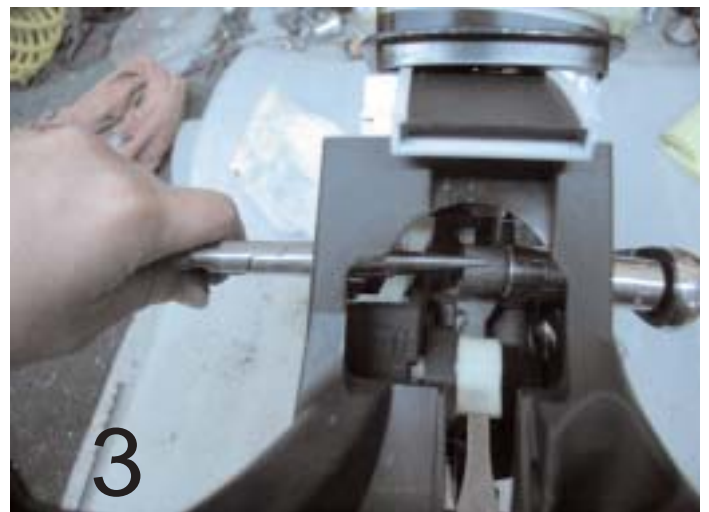

**STEP 4:**

Install modified cable end onto shifter lever, threaded all the way in.



**STEP 5:**

Install jam nuts and washer into the factory cable location and tighten.

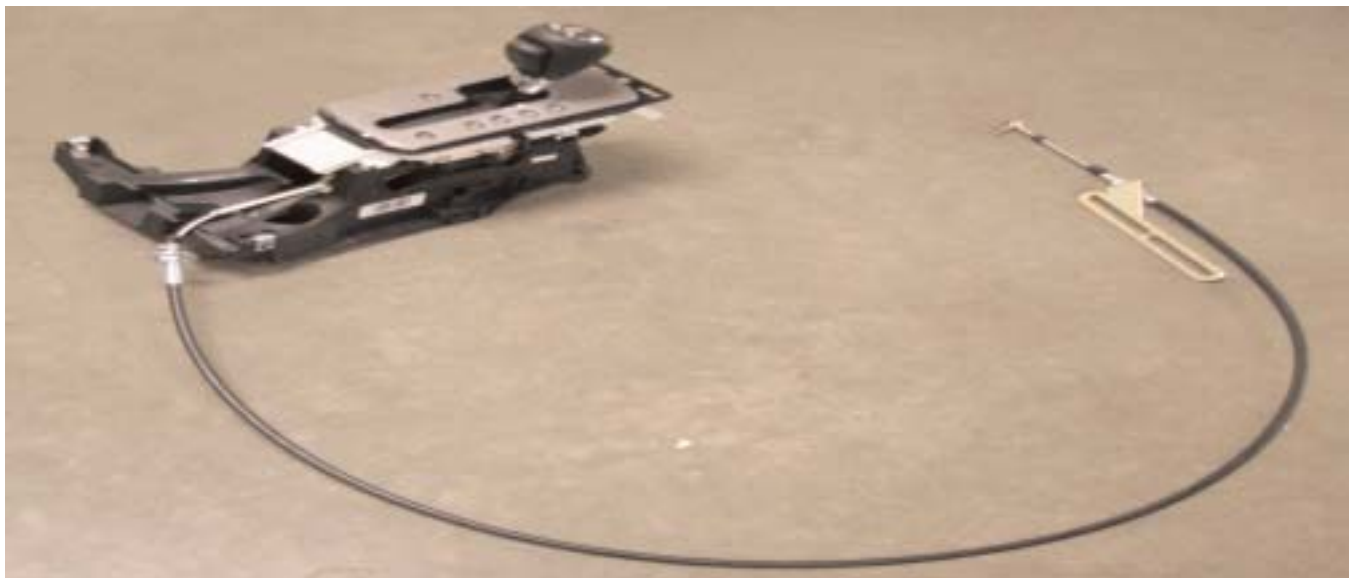

**STEP 6:**

Remove left hand (driver side) rear two trans pan bolts, using supplied 6X25 bolts and 5/16" spacers, install shifter cable bracket. Note shifter cable hole goes in the forward and upward position.



**STEP 7:**

Install shifter cable into bracket.

**STEP 8:**  
Install pivoting rod end onto threaded shifter cable end.



**STEP 9:**  
Install adjustable shifter lever linkage. Pulling lever to forward location should be park position.



**STEP 10:**  
Install pivoting rod end into adjustable rod linkage with large washers into the cable stub thread end of the threads.

From this point adjustment can be made to get proper gear selection on the transmission and indicator on the shifter. To make the tap up tap down mode work, the shifter will have to be adjusted with a scanner. This is a fine adjustment that will let the transmission know that the transmission lever is in sport mode, when the gear selector is pulled into tap up tap down mode. If the transmission is not in this mode, tap up tap down will not work. When this adjustment is made, check all gear selections again to make sure the other gear selections are properly engaging.

**TAP UP TAP DOWN  
G6 SHIFTER**



PIN	WIRE	CIRCUIT	FUNCTION
A	GRAY	8	INSTRUMENT PANEL LAMP
B	---	---	NOT USED
C	RED/WHITE	339	IGNITION VOLTAGE
D	GREEN	5525	TAP UP/DOWN ENABLE SIGNAL
E	GREEN/BLACK	1135	BRAKE TRANS SHIFT INTERLOCK SOLENOID
F	PURPLE	5526	TAP UP/DOWN SWITCH SIGNAL
G	BLACK/WHITE	1150	GROUND
H	---	---	NOT USED